

© Copyright
This drawing and any design hereon is the copyright of the
Consultants and must not be reproduced without their written
consent.

All drawings remain the property of the Consultants.

LEGEND

PROPOSED SURFACE WATER DRAIN AND MANHOLE	
EXISTING SURFACE WATER DRAIN AND MANHOLE	
PROPOSED FOUL WATER DRAIN AND MANHOLE	
EXISTING FOUL WATER DRAIN AND MANHOLE	
PROPOSED FOUL RISING MAIN	
EXISTING FOUL RISING MAIN	
SURFACE WATER OUTFALL	
PROPOSED SPOT LEVELS	
SITE BOUNDARY	

NOTES:

UP TO INSPECTION CHAMBERS, THE FOUL SEWER SYSTEM HAS BEEN DESIGNED AND DETAILED IN ACCORDANCE WITH IRISH WATER'S CODE OF PRACTICE FOR WASTEWATER INFRASTRUCTURE (IW-CDS-5030-03) AND IRISH WATER'S WASTEWATER INFRASTRUCTURE STANDARD DETAILS (IW-CDS-5030-01).

THE FOUL SEWER SYSTEM IS TO BE CONSTRUCTED IN ACCORDANCE WITH IRISH WATER'S CODE OF PRACTICE FOR WASTEWATER INFRASTRUCTURE (IW-CDS-5030-03) AND IRISH WATER'S WASTEWATER INFRASTRUCTURE STANDARD DETAILS (IW-CDS-5030-01).

CONSTRUCTION OF THE FOUL SEWER SYSTEM SHALL ENSURE REQUIRED SEPARATION DISTANCES AS SPECIFIED IN SECTION 3.5 OF IW-CDS-5030-03.

FOUL SEWERS TO BE THERMOPLASTIC STRUCTURED WALL PIPES IN ACCORDANCE WITH SECTION 3.13 OF IW-CDS-5030-03.

FOUL SERVICE CONNECTIONS TO BE UPVC PIPES IN ACCORDANCE WITH SECTION 3.12 OF IW-CDS-5030-03.

MANHOLES TO BE PRECAST CONCRETE AND IN ACCORDANCE WITH SECTION 3.12 OF IW-CDS-5030-03 AND STD-WW-10 OF IW-CDS-5030-01, WITH BACKDROP MANHOLES TO BE AS PER STD-WW-12.

PRIVATE-SIDE INSPECTION CHAMBERS SHALL BE AS PER STD-WW-13.

WHERE LOCATED IN UNPAVED AREAS, MANHOLE COVERS TO BE SURROUNDED WITH A CONCRETE PLINTH AS PER NOTE 9 OF STD-WW-10 AND FORMED WITH C20/25 CONCRETE, 20MM AGGREGATE SIZE, BEDDED IN CLAUSE 804 MATERIAL.

P11	S4	For Planning	JL	PMCE	15.04.19
P10	S4	For Planning	JL	PMCE	29.03.19
P09	S4	Updated Site Layout	JL	PMCE	21.03.19
P08	S4	Pumping Station Outline Revised	PH	PMCE	14.03.19
P07	S4	Revised Tanker Access	JL	PMCE	12.03.19
P06	S4	For Irish Water Review	JL	PMCE	08.03.19
P05	S4	For Irish Water Review	JL	PMCE	06.03.19
P04	S4	Revised Site Layout	JL	PMCE	02.01.19
P03	S4	Stage Approval	PH	JF	12.09.18
P02	S3	For Review	PH	PMCE	10.09.18
P01	S3	For Review	PH	PMCE	17.07.18
Rev.	Sut.	Description	Drawn	Ch'kd	Date

Client
CAIRN HOMES PROPERTIES LTD.

Clients Representative:



3 Eastgate Road, Eastgate tel +353 21 475 7800
Business Park, Little Island, web www.jbbarry.ie
Co. Cork, Ireland email cork@jbbarry.ie

Project
STRATEGIC HOUSING DEVELOPMENT CASTLETREASURE

Drawing Title
PROPOSED FOUL AND SURFACE WATER DRAINAGE LAYOUT - OVERALL

Drawn by:	PH	Date:	06.07.18
Checked by:	PME	Date:	06.07.18
Approved by:	TF	Date:	06.07.18

Internal Project REF: JBB: 18203
Scales: 1:1250 @ A1; 1:2500 @ A3

Stage: PLANNING		
Drawing No.:	Revision	Suitability Code
18203-JBB-1A-XX-DR-C-0500	P11	S4

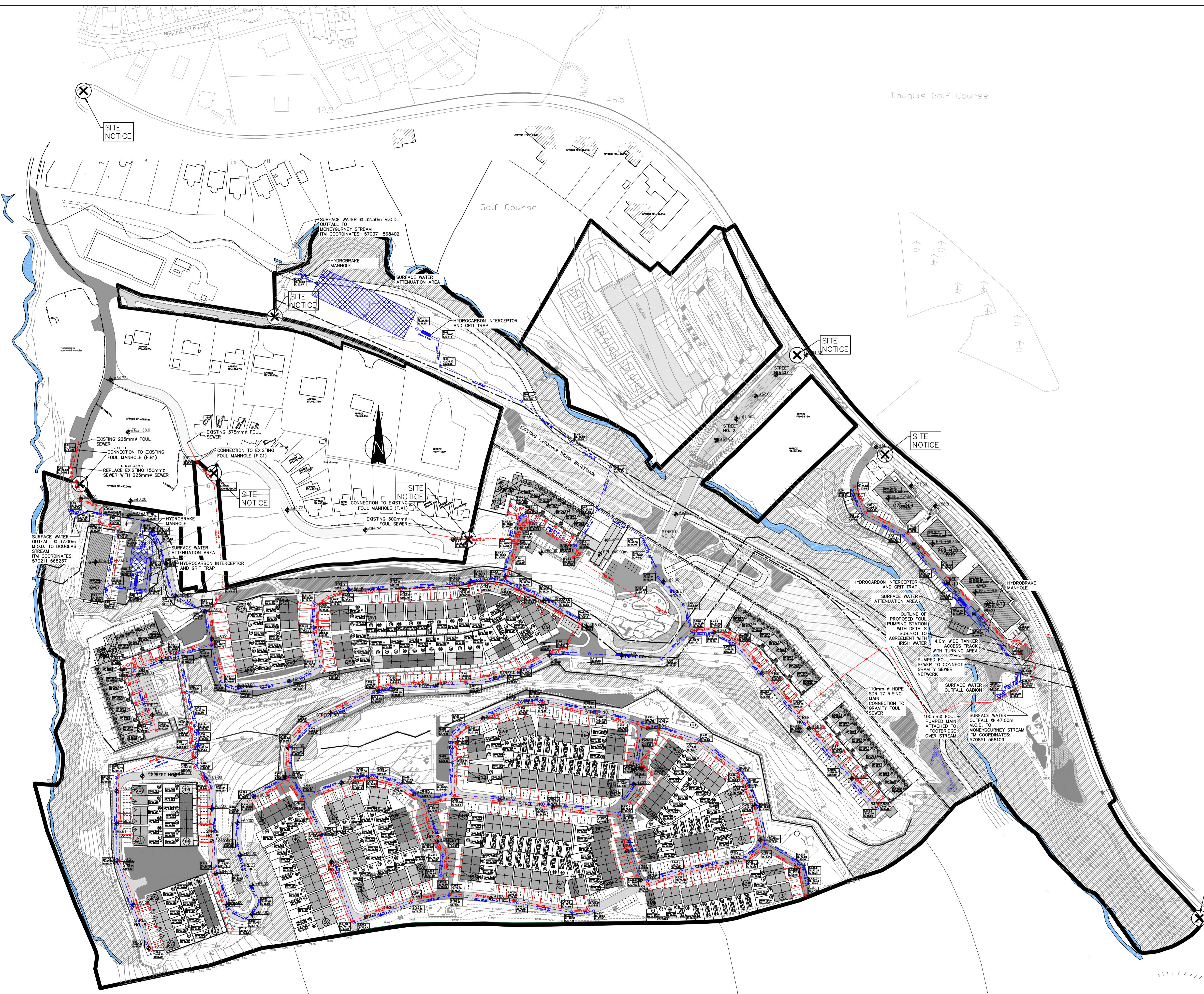

P:\Barry's Project Files\18 Projects\18203-Cairn Homes Development\001 Work in Progress\01_Civil\02_Drawings\18203-JBB-1A-XX-DR-C-0500_Proposed_Foul_and_Surface_Water_Drainage_Layout_-_Overall_P11.dwg